

# WELCOME TO OUR NEW HOME !

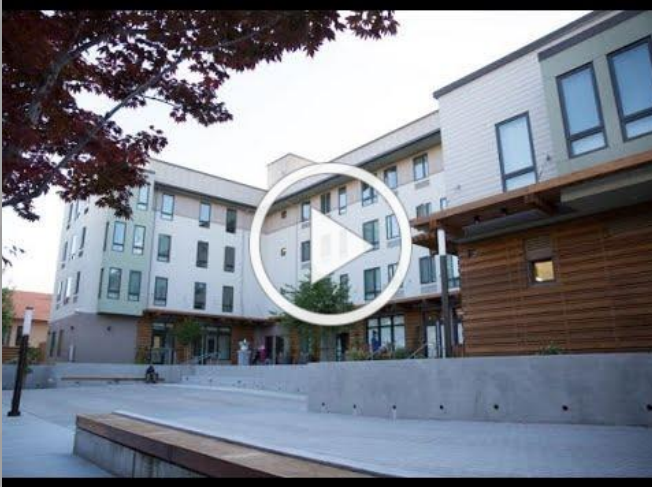

We are delighted to share the long awaited debut of the NEW Trinity Center at St. Paul's Commons! Click the video for a virtual photo tour. These beautiful photos, captured by **Zella Urmson Photography**, were taken one early morning before our Center opened.

If you are interested in a tour, please contact us so we can make arrangements, in keeping with social distancing protocol.

[Click to CONTACT US](#)

[WWW.ZELLAURMSONPHOTOGRAPHY.COM](http://WWW.ZELLAURMSONPHOTOGRAPHY.COM)

## OUR DAY PROGRAM PROVIDES CRUCIAL SERVICES



Trinity Center's day shelter meets people's crucial needs for food, clothing, cleanliness, security, support, communication & healthcare. We provide over 56,000 services a year, serve an average of 50 people daily and more than 970 individuals each year. Member Advocates provide case management for benefits, housing, employment and supportive services, with the help of partner providers. Certified Addiction Treatment Counselors provide group counseling & individualized services and we employ homeless and marginalized persons to build self-sufficiency.

**INTERESTED IN**

# VOLUNTEERING?

As we are settling in to our new home and adjusting to a post-COVID world, we are actively assessing and planning for our wonderful volunteers to come back and inviting new folks to join our mission. Please stay tuned for more information!

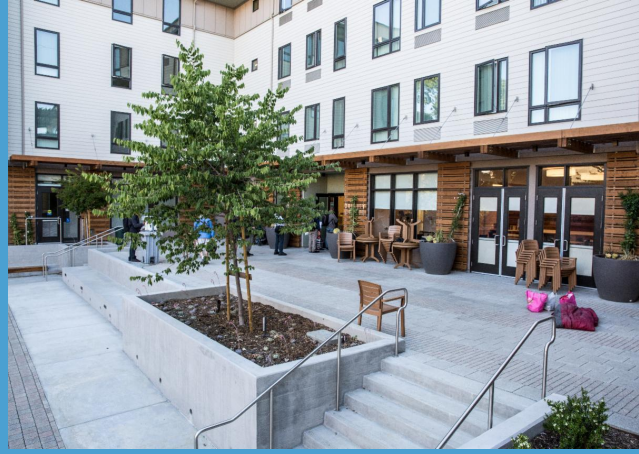

## NEW FISCAL YEAR!

With the beginning of July comes not only our new Fiscal Year, but the second half of 2020! We will soon report on our year over year facts and figures.

We are so grateful to remain open as an essential service to during the pandemic to be able to continue meeting the growing needs of our community.



# 18,866

Represents the total # of services provided  
January-June 2020!

- 7,196 Meals
- 2,863 Showers
- 873 Loads of Laundry
- 6,268 Clothing Items
- 1,702 Pantry Items

### Growth Trends post COVID-19

- 25% growth NEW Members
- 38% growth in Females
- 30% growth in Males ages 25-44
- 51% growth in Females ages 55+
- 29% growth in Domestic Violence Victims
- 53% growth in Chronic Illness
- 68% growth in Physical Disability
- 31% growth in Chronic Homeless

## ACCESSORIZE FOR A CAUSE!



**ckelly accessories**  
*effortless. affordable. irresistible.*

Thursday, July 16, 2020

**4:00 PM to 5:00 PM**

Join us us for a fashionable fundraiser!  
Experience custom styling featuring  
CC Kelly Accessories. Find effortless,  
affordable and irresistible items to add to  
your collection, or give as a gift!

Click below for the Live YouTube  
link...be sure to say "hello" in the  
Comments!

[YouTube Link](#)



**Click the Link to view a quick and  
easy styling session - learn how to  
use scarves to accessorize and below  
to shop your favorite!**

**10% OFF &  
FREE SHIPPING**

Pre-Order and SAVE 10%!  
*Enter code: EARLY at checkout*

Pick-Up order at Trinity Center for Free  
Shipping  
*Enter Code: PICKUP*

[SHOP NOW](#)

[MAKE A DONATION](#)

